



**The Timken Company**

4500 Mt Pleasant St. NW

N. Canton, OH 44720

Phone: (234) 262-3000

E-Mail: [CustomerCAD@timken.com](mailto:CustomerCAD@timken.com) • Web site: [www.timken.com](http://www.timken.com)

## Part Number 6201-2RZ-NR, Deep Groove Ball Bearings (6000, 6200, 6300, 6400)

Timken's deep groove ball bearings deliver reliable performance in a wide range of applications and conditions. With super-finished raceways and controlled geometries, our premium design helps ensure consistent quality.



[Specifications](#) | [Dimensions](#) | [Basic Load Ratings](#) | [Factors](#)

### Specifications

Clearance	C0 (Normal)
Bore Size d	12.000 mm
Features	Non-Contact Seals With Snap Ring
Bearing Type	Standard DGBB
Weight	0.040 Kg

### Dimensions

Outside Diameter D	32.000 mm
Outside Ring Width B	10.000 mm



Radius Rs min	0.600 mm
Snap Ring Diameter D2 max	36.700 mm
Snap Ring Width f max	1.120 mm

## Basic Load Ratings

Cr - Dynamic Load Rating	6.8 kN
C0r - Static Load Rating	3 kN

## Factors

Grease Reference Speed	21000 rpm
Oil Reference Speed	30000 rpm

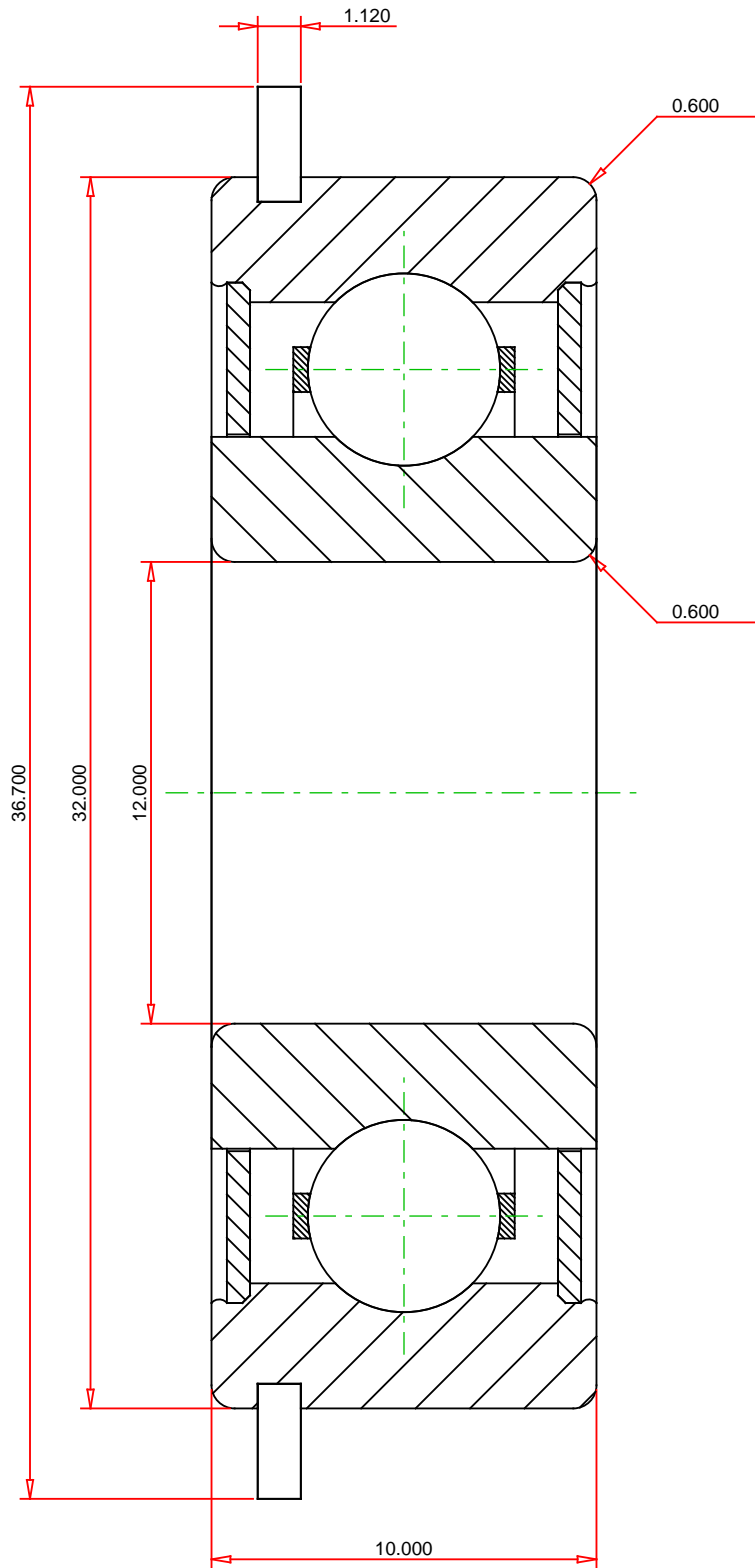

METRIC UNITS

Weight 0.04 kg

**TIMKEN**®

**THE TIMKEN COMPANY**  
NORTH CANTON, OHIO USA

**6201-2RZ-NR**  
Deep Groove Ball Bearings (6000, 6200, 6300, 6400)

Dynamic Load Rating 6800 N  
Static Load Rating 3000 N

Every reasonable effort has been made to ensure the accuracy of the information contained in this writing, but no liability is accepted for errors, omissions or for any other reason.

**FOR DISCUSSION ONLY**